

INDUSTRIAL PROPERTY FOR LEASE

30,800 - 116,400 SF Available

KING Industrial
Realty, Inc.



5215 Westgate Drive, Atlanta, GA 30336

OFFERING SUMMARY

Available SF: 30,800 - 116,400 SF
Lot Size: 5.52 Acres
Building Size: 116,400 SF
Zoning: M1A

PROPERTY HIGHLIGHTS

- 5,760 SF Office
- 22' Clear Height
- 40' x 40' Column Spacing
- High Efficiency T-5 Lights
- 19 Dock High Doors
- 1 Drive - In Door
- Front Load Building
- 88 Car Parks or Trailer Storage

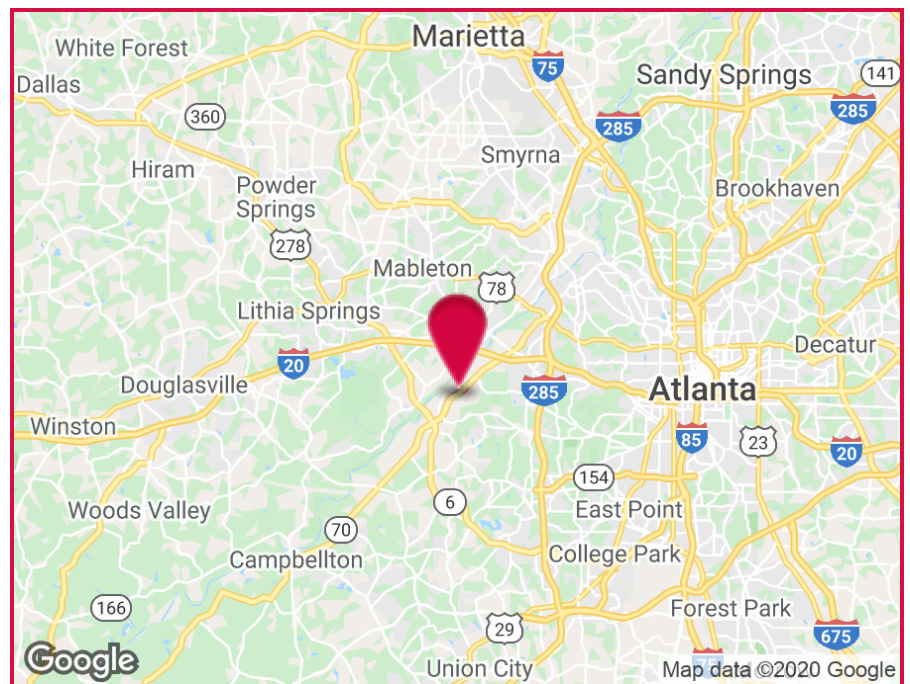

For More Information Contact:

WILSON COVINGTON, SIOR	RANDALL BRYAN, SIOR
Senior Vice President	Vice President
404.942.2073	404.942.2015
wcovington@kingindustrial.com	rbryan@kingindustrial.com

INDUSTRIAL PROPERTY FOR LEASE
30,800 - 116,400 SF Available
5215 Westgate Drive, Atlanta, GA 30336

King Industrial
Realty, Inc.



For More Information Contact:

WILSON COVINGTON, SIOR	RANDALL BRYAN, SIOR
Senior Vice President	Vice President
404.942.2073	404.942.2015
wcovington@kingindustrial.com	rbryan@kingindustrial.com

INDUSTRIAL PROPERTY FOR LEASE

30,800 - 116,400 SF Available
5215 Westgate Drive, Atlanta, GA 30336

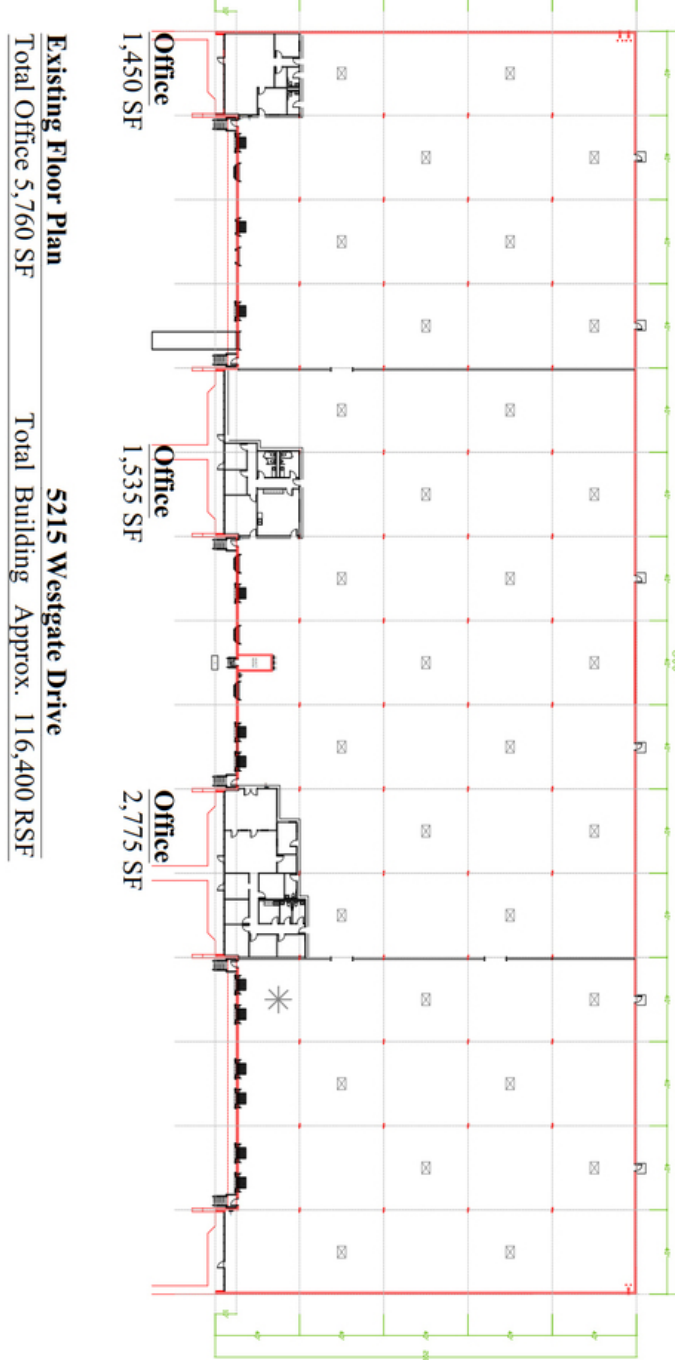

For More Information Contact:

WILSON COVINGTON, SIOR	RANDALL BRYAN, SIOR
Senior Vice President	Vice President
404.942.2073	404.942.2015
wcovington@kingindustrial.com	rbryan@kingindustrial.com

INDUSTRIAL PROPERTY FOR LEASE

30,800 - 116,400 SF Available
5215 Westgate Drive, Atlanta, GA 30336

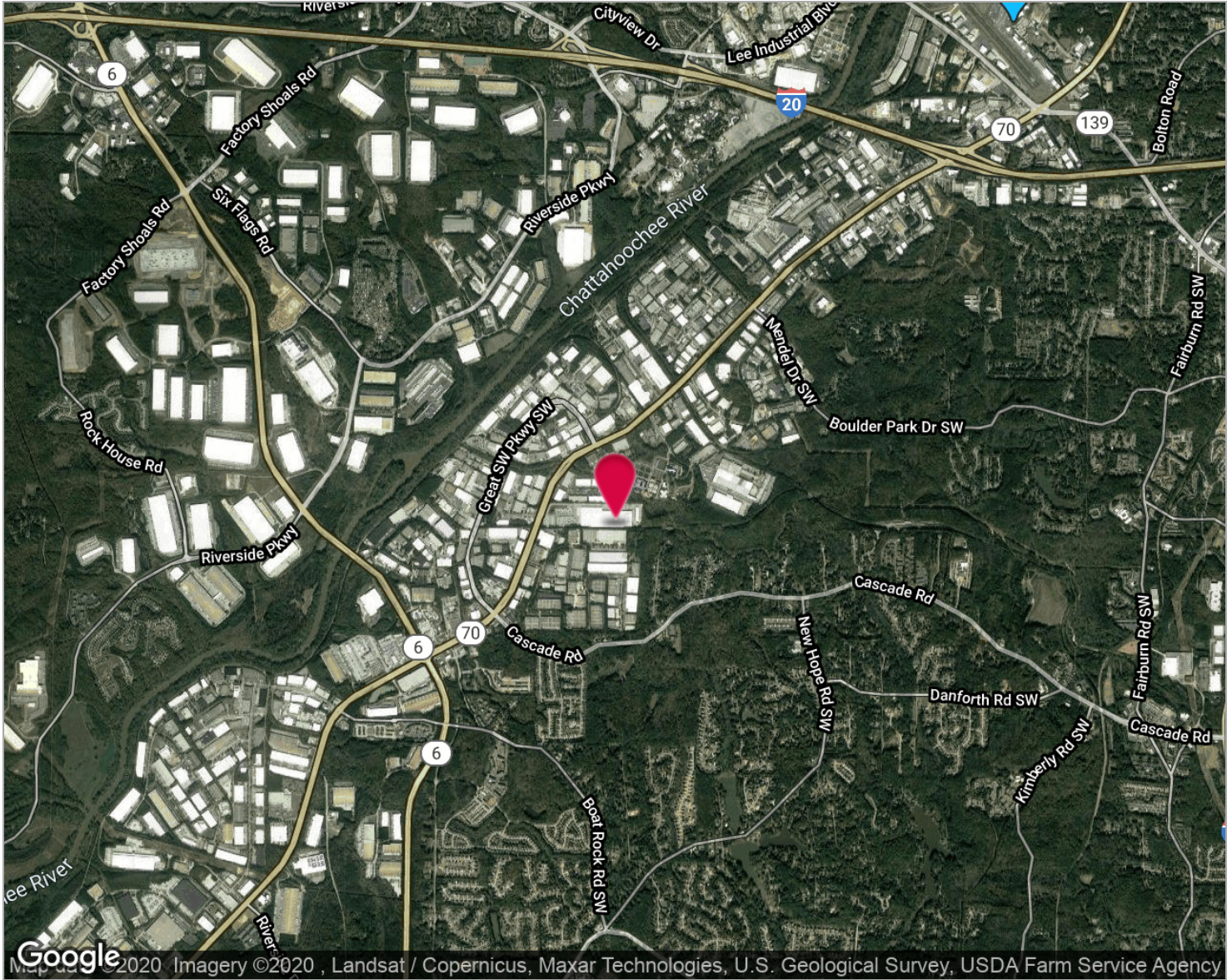

LOCATION DESCRIPTION

Located in the Fulton Industrial District of Atlanta, GA. Minutes to Interstate 20.

For More Information Contact:

WILSON COVINGTON, SIOR	RANDALL BRYAN, SIOR
Senior Vice President	Vice President
404.942.2073	404.942.2015
wcovington@kingindustrial.com	rbryan@kingindustrial.com