

INDUSTRIAL PROPERTY FOR LEASE

33,126 SF Available

KING Industrial
Realty, Inc.



5275 Westgate Drive, Suite A, Atlanta, GA 30336

OFFERING SUMMARY

Available SF:	33,126 SF
Lot Size:	4.17 Acres
Year Built:	1985
Building Size:	66,605 SF
Zoning:	M1A
Submarket:	Fulton Industrial

PROPERTY HIGHLIGHTS

- 2,586 SF Office
- 7 Dock High Doors (5 w/Levelers)
- 1 Drive In Ramp
- Front Loading
- 22' Clear Height
- 33' x 40' Column Spacing
- 109' Deep Truck Court
- Energy Efficient T-5 Lighting

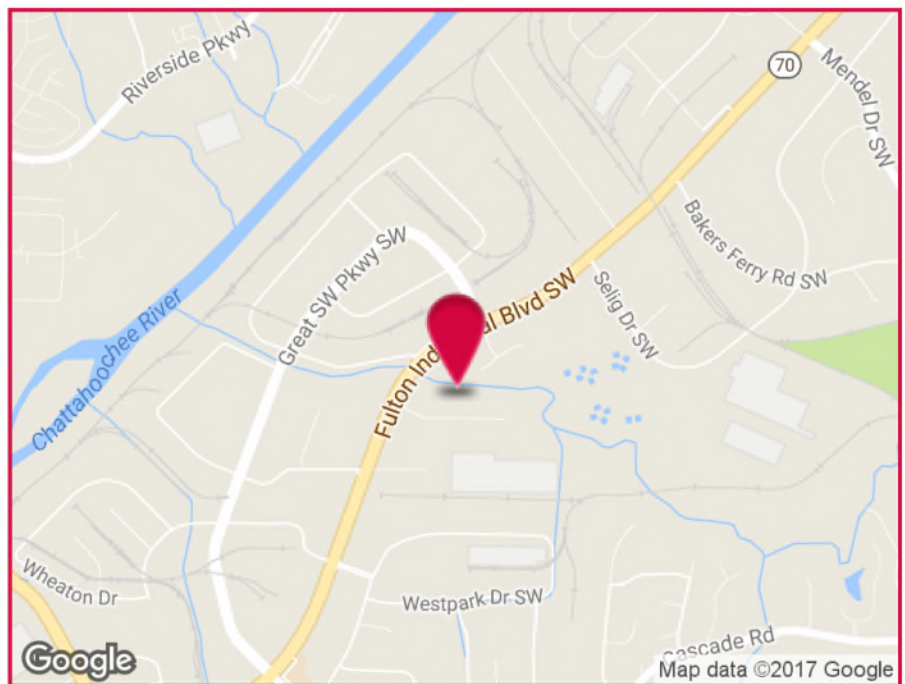

For More Information Contact:

WILSON COVINGTON

Senior Vice President

404.942.2073

wcovington@kingindustrial.com

RANDALL BRYAN

Sales Associate

404.942.2015

rbryan@kingindustrial.com



INDUSTRIAL PROPERTY FOR LEASE

33,126 SF Available

5275 Westgate Drive, Suite A, Atlanta, GA 30336

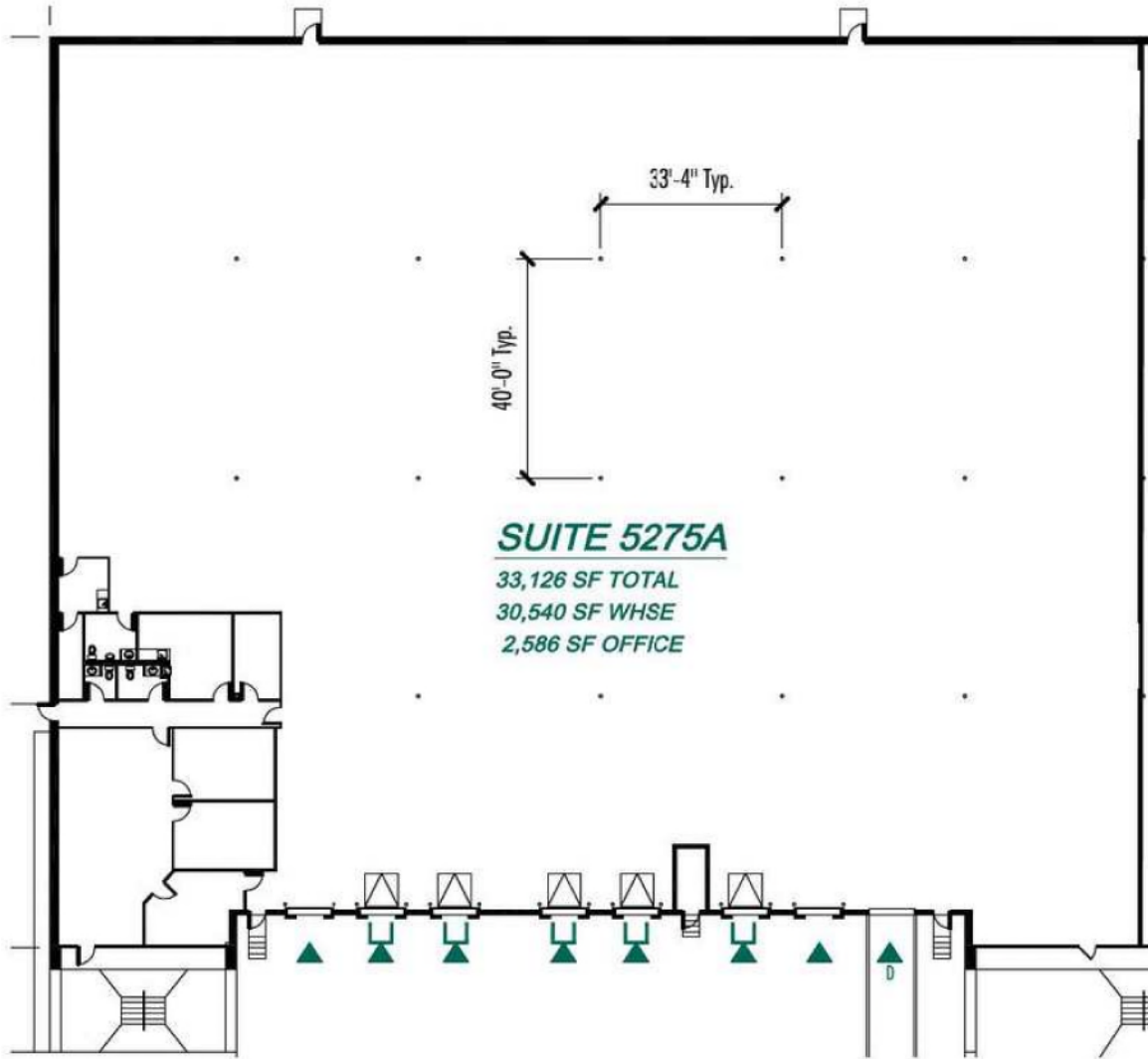

For More Information Contact:

WILSON COVINGTON

Senior Vice President

404.942.2073

wcovington@kingindustrial.com

RANDALL BRYAN

Sales Associate

404.942.2015

rbryan@kingindustrial.com



INDUSTRIAL PROPERTY FOR LEASE

33,126 SF Available

5275 Westgate Drive, Suite A, Atlanta, GA 30336

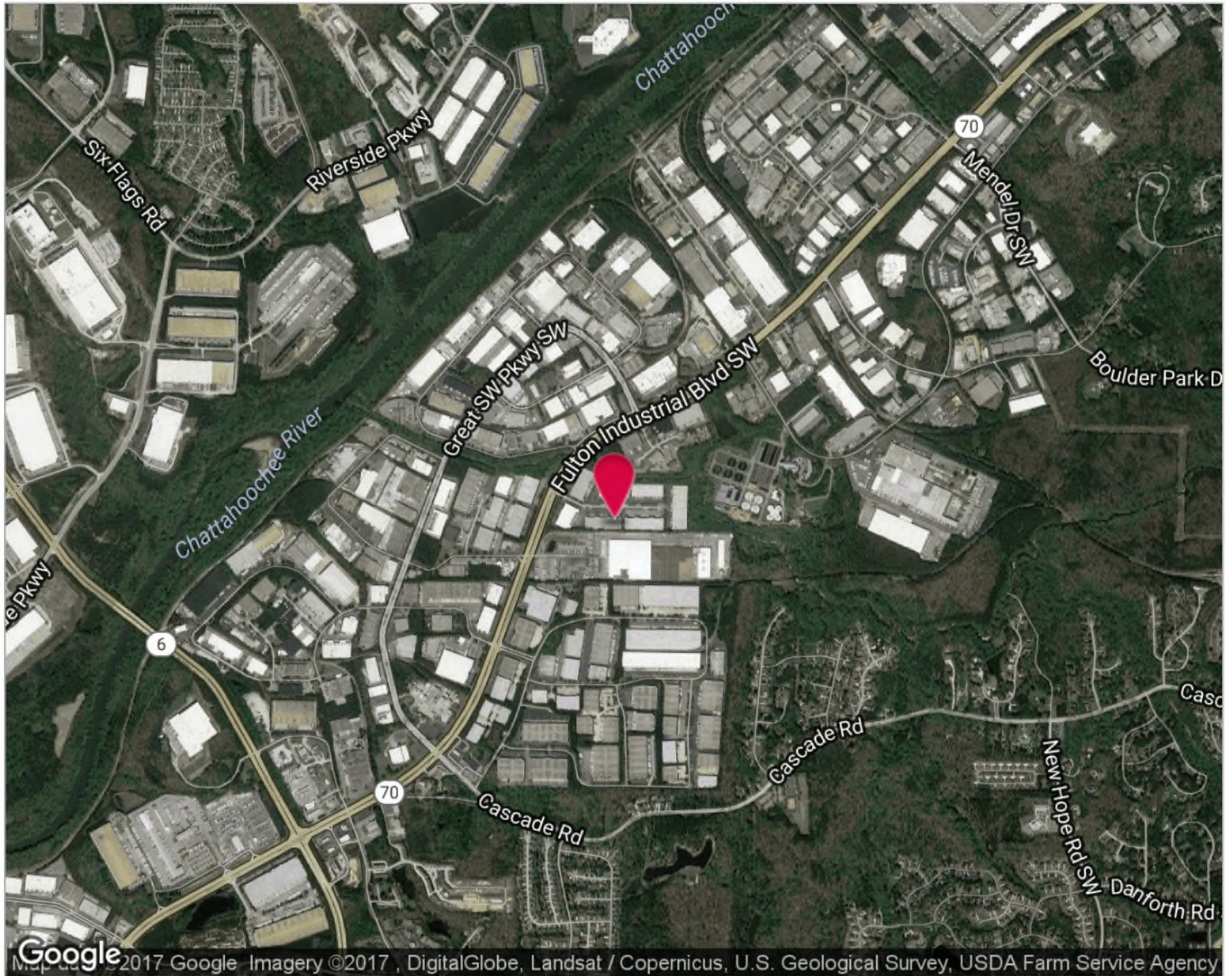

LOCATION DESCRIPTION

Conveniently located near I-20.

Approximately 13.5 Miles to Hartsfield-Jackson Atlanta International Airport

For More Information Contact:

WILSON COVINGTON

Senior Vice President

404.942.2073

wcovington@kingindustrial.com

RANDALL BRYAN

Sales Associate

404.942.2015

rbryan@kingindustrial.com



1920 Monroe Dr., NE. Atlanta, GA 30324 • 404.942.2000 • www.kingindustrial.com

Every effort has been made to provide accurate information, but no liability is assumed for errors and omissions